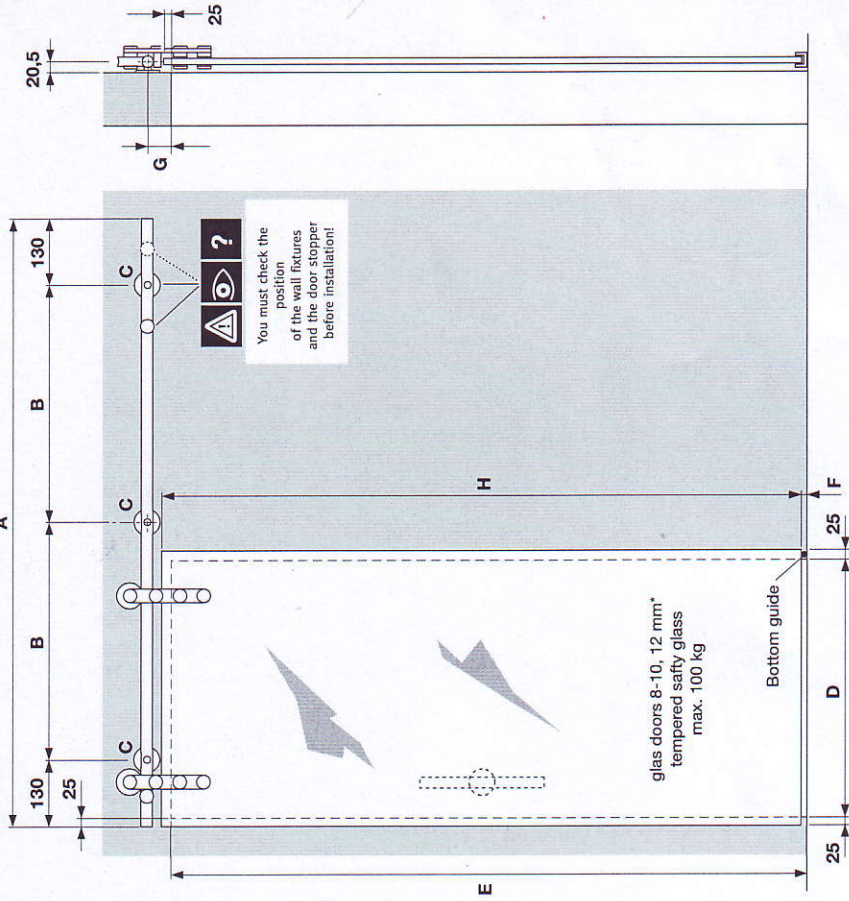


# Installation instructions

## Sliding door fittings Flatec I

for glass doors ( 8-12 mm )



Complete-sets (standard model for 8-10 mm glass doors \*)

Set Flatec I Art. No.	A mm	B mm	C Each	D mm	E max. mm	F mm	G mm	H max. mm (H = E - F + 25)
USO44-1800EF	1800	770	3	750 - 900	2500	7 - 10	60	2518
USO44-2100EF	2100	613,3	4	910 - 1000	2500	7 - 10	60	2518
USO44-2300EF	2300	680	4	1010 - 1120	2500	7 - 10	60	2518
USO44-2540EF	2540	760	4	1130 - 1250	2500	7 - 10	60	2518

\*) for glass door 1/2" please use bottom guide art.-no. USO264EF.

Right to make technical changes reserved - Dimensions in mm - Version 06.2007

© by ABP-Beyerle GmbH

ABP Beyerle

- Attention
- Screw on
- Screw on
- Screw on
- Loosen / Tighten
- Install
- At right angle
- Drill
- Dowels
- Adjust Set
- Level
- Perpendicular
- Measure Mark
- Visual inspection
- Special-tool
- 2 people required
- Measure
- Clarify questions
- See instructions
- Secure

USO44-68

**1** Set sliding door fittings Flatec I

**2** Guide rail

**3** Door stoppers

**4** Trolley complete

**5** Wall fixtures (without dowels, at construction site)

**6** Special tool

**7** Bottom guide

\*not included in scope of delivery.

For glass door 1/2" please use bottom guide art.-no. USO264EF (without dowels and screws, at construction site)

Comply with all general safety regulations when installing the sliding door fittings!

Be sure to tighten all screw connections one week after starting to use the sliding door fittings!

Never use scouring agents to clean the sliding door fittings; rather use commercially available stainless-steel cleaners!

Set Flatec I (Glass doors 8-10 mm)	Set / Each						
1 Art. No.	2	3	4	5	6	7	
USO44-1800EF	1	2	2	3	2	1	
USO44-2100EF	1	2	2	4	2	1	
USO44-2300EF	1	2	2	4	2	1	
USO44-2540EF	1	2	2	4	2	1	

**ABP Beyerle**

ABP-Beyerle GmbH  
 Im Schollengarten 24 b, D - 76646 Bruchsal (Germany)  
 Tel. + 49 - (0) 7257 / 9127 - 0, Fax + 49 - (0) 7257 / 9127 - 29, Email info@abp-beyerle.de, www.abp-beyerle.de





Fig. 1

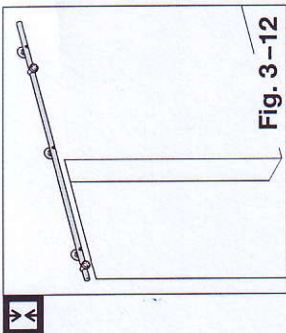


Fig. 2

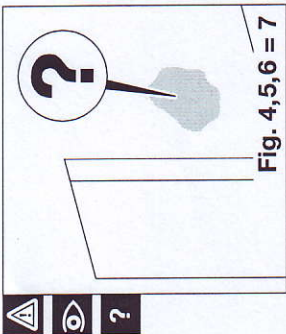


Fig. 3

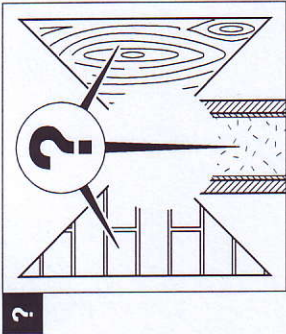


Fig. 4

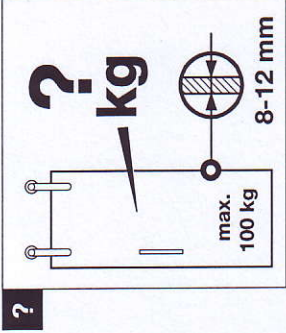


Fig. 5

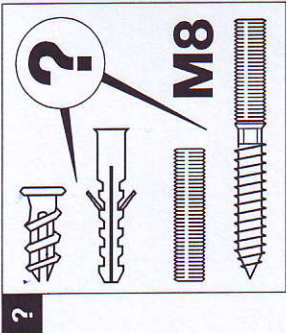


Fig. 6

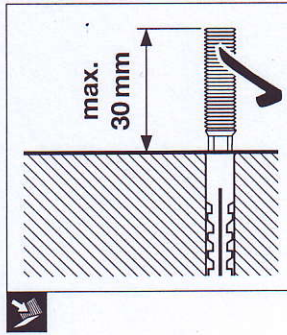


Fig. 7

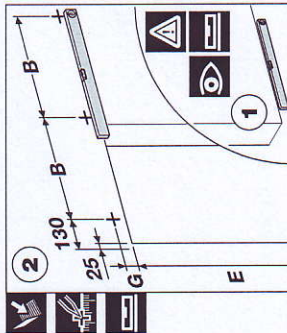


Fig. 8

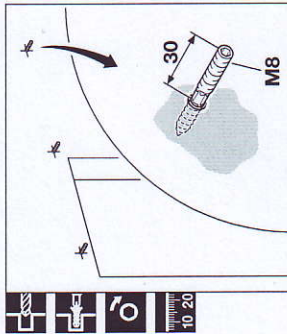


Fig. 9

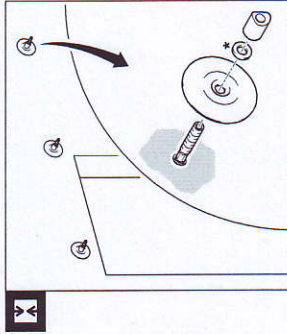


Fig. 10

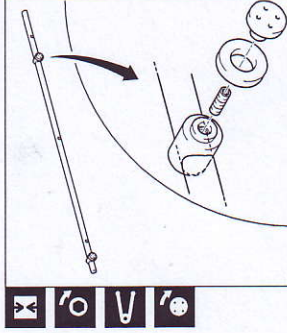


Fig. 11

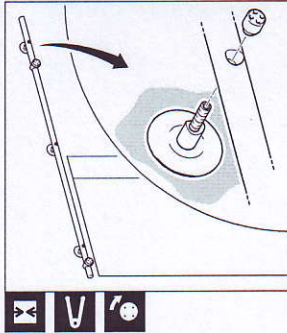


Fig. 12

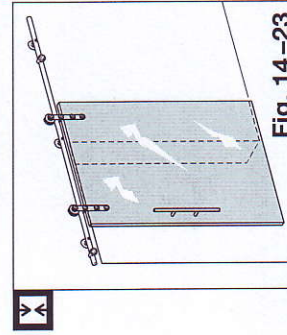


Fig. 13

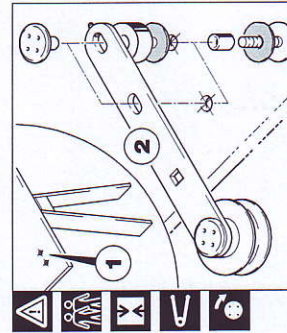


Fig. 14

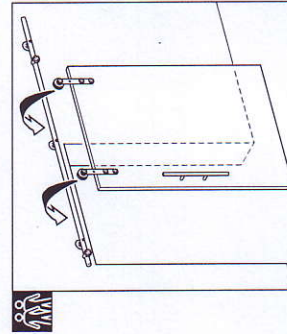


Fig. 15

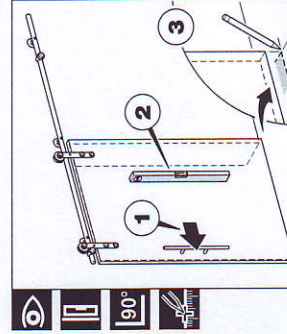


Fig. 16

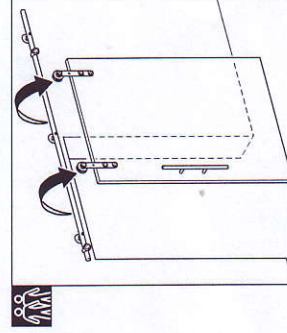


Fig. 17

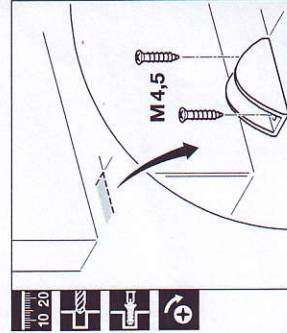


Fig. 18

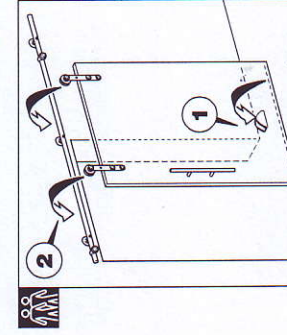


Abb. 19

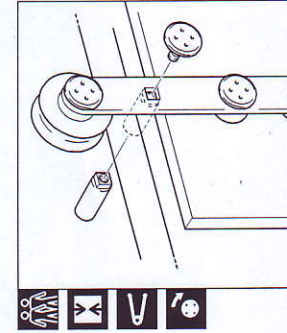


Fig. 20

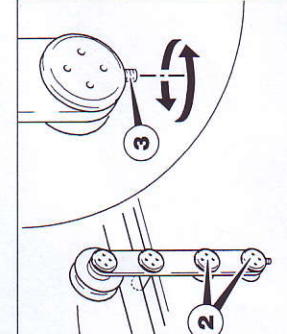
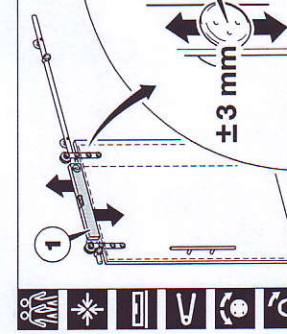


Fig. 21

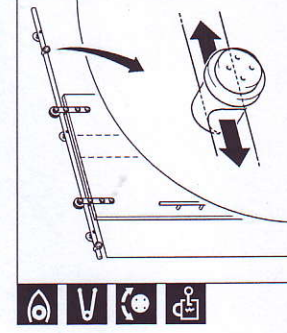


Fig. 22

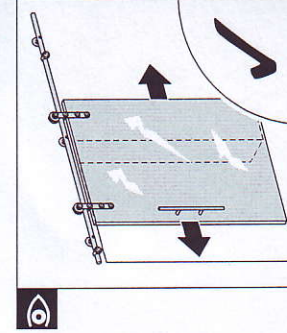


Fig. 23

Installation instructions Sliding door fittings Flatec I  
for glass doors (8-12 mm)